



DID YOU KNOW?

- ∞ The suction from a pool drain can be so powerful that it can hold an adult under water. Most drain related incidents involve children. Consider installing a Safety Vacuum Release System (SVRS), which detects when a drain is blocked and automatically shuts off the pool pump or interrupts the water circulation to prevent entrapment.
- ∞ Nearly 9 of 10 drowning related deaths happen while a child is under some form of supervision, according to a Safe Kids Worldwide study.
- ∞ Beyond the fun and fitness they provide, an inground pool raises the home's value nearly eight percent according to the National Association of Realtors! (Pool & Spa Living, May 2008)

Why Do I Need a Permit?

There are many important reasons to obtain building permits and to have inspections performed for your construction project the following are just a few.

Protects property values

Your home is typically your largest investment. If your construction project does not comply with the building codes, your investment could lose value. If others in your neighborhood make unsafe or substandard changes to their homes, it could lower the resale values for the entire community.

Saves Money

Homeowners insurance policies may not pay for damages caused by work done without permits and inspections.

Makes Selling Property Easier

Listing associations require owners to disclose any home improvements or repairs and if permits were obtained. Many financial institutions will not finance a purchase without proof of a final inspection. If you decide to sell a home or building that has had modifications without a permit, you may be required to tear down the addition, leave it unoccupied or do costly repairs.

Improves safety

Your permit allows the building department to inspect for potential hazards and unsafe construction. By ensuring your project meets the minimum building code standards of safety, the building department can reduce the risk of fire, structural collapse and other issues that might result in costly repairs, injuries and even death. Inspections complement the contractor's experience and act as a system of checks and balances resulting in a safer project.

It's the Law

Permits are required by ordinance. Work without a permit may be subject to removal or other costly remedies.

The purpose of this guide is to assist you in the permitting process. This handout is intended to cover information for a basic plan submittal and typical project under the building codes. It is not intended to cover all circumstances. Depending on the scope and complexity of your project, additional information may be required. Discuss your project with City staff to determine if it is subject to additional requirements.

What do I need in order to apply for a building permit? The following must be submitted:

<input type="checkbox"/>	Site Plan	Page 2
<input type="checkbox"/>	Plan Requirements	Page 2
<input type="checkbox"/>	Required Inspections	Page 3
<input type="checkbox"/>	Fence Detail	Page 4
<input type="checkbox"/>	Contact Information	Page 4
<input type="checkbox"/>	Permit Application	



What is a Site Plan?

A site plan is a detailed drawing of your property, also known as a survey of your land. These are usually drawn by a land surveyor. The site plan will show the dimensions of your project and its relationship to existing setbacks, easements, utilities, other structures on the property, and distance to your property lines. If your project will require moving any utilities (gas, water, sewer/septic, electric, etc.), show where those meters will be relocated.

What is REQUIRED for a Permit?

- Provide copies of the SITE PLAN

Notes:

1. Structures must meet zoning requirements.
2. A survey from a registered land surveyor will be required if your project is located within the setbacks or in a protected area. A variance from the City of Yonkers may also be required.
3. If your property is on a slope, you may be required to install silt fence to keep the dirt on your property.
4. If you are on a septic tank, you may be required to have approval from the county health department prior to submitting your pool application.
5. If you do not know the location of your utilities, contact MISSDIG. ()
6. Certificate of elevation may be required on any lot of record that includes or abuts any portion of a flood plain.
7. Entry to your pool must be secured, and a fence or other barrier must be shown on the site plan.

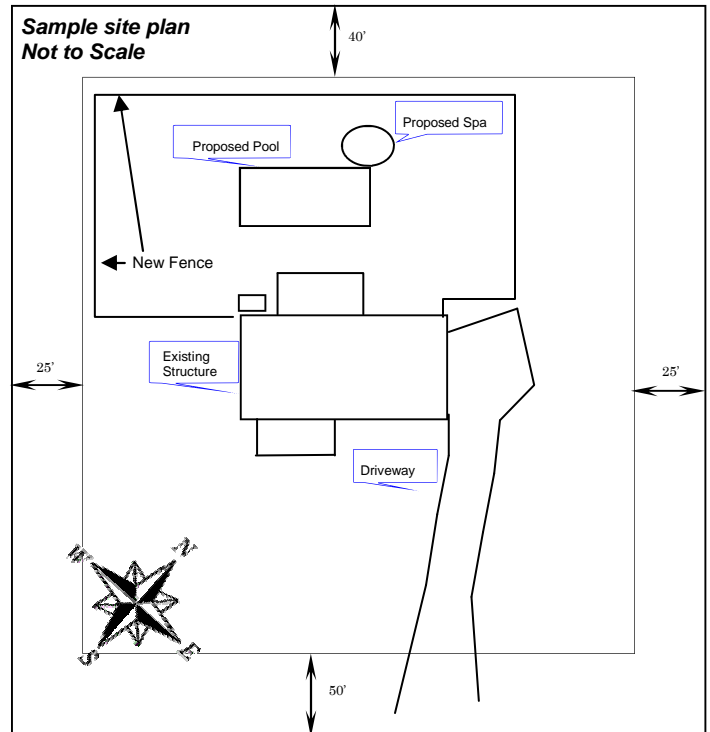

Construction Plan Requirements

What is REQUIRED for a Permit?

- Provide copies of a POOL PLAN, drawn at a legible scale. Such plans shall include details, drawings, and notes that sufficiently describe the work to be done and clearly shows building code compliance: Include the following :
 - Address, lot number, owner's name & contact information, designer's name & contact information, list of plan pages in the set.
 - Dimensioned, detailed plans showing pool location, decking, fencing, equipment location, retaining walls, spas, pool house location, fire pits, etc.
 - Location of electric meters & panels, pool heater gas lines, overflow, backwash, pool fill, etc.

- Profile section of pool
- Entrapment protection provisions
- Heated pools require covers or other energy conservation measures per International Energy Code
- Any additional information needed to show ANSI/NSPI compliance
- Include any notes or statements on the plan that clarify what work is to be by the pool contractor and what work is to be completed by the property owner
- Notes and/or statements on the plans that clarify who will be responsible for alarm installation, fencing and landscape requirements.

NOTES

- Separate structures (Pool houses, outdoor fireplaces, etc.) all require a separate permit.
- For above ground pools purchased as a "do-it-yourself" kit, you must provide the pool manufacturer's printed product literature, installation instructions, and pool deck/stair construction details.

Tips For Hiring Contractors

- ◆ Hire only licensed contractors
- ◆ Get at least 3 bids—Get 3 references and ask to see a project
- ◆ Get it in writing - but before you sign the contract, make sure you completely understand
- ◆ Don't make final payment until you have a signed contract and you are satisfied
- ◆ Have the contractor apply for the required permits

What the inspector will look at: Required Inspections

1. Pool Structure.

IN GROUND POOLS (Basket)

- Made after the pool has been excavated and cleaned of all loose soils, debris, and organic matter all required forms are in place and properly supported
- All drain and circulation piping is in place and under required test.
- All reinforcement steel is in place, properly tied, and supported with concrete bricks or approved chairs to guarantee the required 3" minimum cover.
- All electrical conduits, lighting fixtures (or shells), etc are in place and properly supported.
- All supports or sockets for ladders, diving boards, etc are in place and properly supported.
- The Basket is completely ready for shotcrete.
- For in ground pools not constructed as above (vinyl liners, fiberglass shell), the manufacturer's installation instructions, NSPI Installation Standards, and/or structural installation plans sealed by a Michigan Registered Design Professional must be on site at all times during construction.

ABOVE GROUND POOLS

Made after erection of the pool structure and before any structural members and connections are covered. The installer must provide safe access to all areas of the pool, have the Manufacturer's installation instructions on site at all times, and be ready to perform any tests of connections required by the inspector.

- 2. Circulation/Drain Piping Test.** To be made with a basket inspection listed above. A water pressure test of 1½ times (150%) the maximum operating pressure is required. Bypass the pool equipment and do not exceed the piping maximum test pressure for the piping.

Exceptions

- Air pressure test of not less than 35 psi (if allowed by the piping manufacturer)
- Listed pre-fabricated package pool assemblies do not require pressure tests.

- 3. Electrical Bonding.** Made when all metal parts of a pool structure, deck bonding grid, and equipment is properly bonded together and ready to be covered. **Note:** Depending on pool design and site conditions, this inspection may require several trips to be completed and shall be at the inspector's discretion.

- 4. Back Flow.** Made prior to or with the final pool inspection. State law requires backflow prevention for all pools connected to a potable water supply. If the pool fill has an indirect connection, protection is usually not required. **Note:** Building inspectors do not make backflow inspections, but will check pool fills for compliance. Only Certified Backflow Testers can perform and Certify backflow tests. Written certification of passing the test must be provided to the building department before a ~~3~~ ⁴ ~~4~~ ⁵ ~~5~~ ⁶ ~~6~~ ⁷ ~~7~~ ⁸ ~~8~~ ⁹ ~~9~~ ¹⁰ ~~10~~ ¹¹ ~~11~~ ¹² ~~12~~ ¹³ ~~13~~ ¹⁴ ~~14~~ ¹⁵ ~~15~~ ¹⁶ ~~16~~ ¹⁷ ~~17~~ ¹⁸ ~~18~~ ¹⁹ ~~19~~ ²⁰ ~~20~~ ²¹ ~~21~~ ²² ~~22~~ ²³ ~~23~~ ²⁴ ~~24~~ ²⁵ ~~25~~ ²⁶ ~~26~~ ²⁷ ~~27~~ ²⁸ ~~28~~ ²⁹ ~~29~~ ³⁰ ~~30~~ ³¹ ~~31~~ ³² ~~32~~ ³³ ~~33~~ ³⁴ ~~34~~ ³⁵ ~~35~~ ³⁶ ~~36~~ ³⁷ ~~37~~ ³⁸ ~~38~~ ³⁹ ~~39~~ ⁴⁰ ~~40~~ ⁴¹ ~~41~~ ⁴² ~~42~~ ⁴³ ~~43~~ ⁴⁴ ~~44~~ ⁴⁵ ~~45~~ ⁴⁶ ~~46~~ ⁴⁷ ~~47~~ ⁴⁸ ~~48~~ ⁴⁹ ~~49~~ ⁵⁰ ~~50~~ ⁵¹ ~~51~~ ⁵² ~~52~~ ⁵³ ~~53~~ ⁵⁴ ~~54~~ ⁵⁵ ~~55~~ ⁵⁶ ~~56~~ ⁵⁷ ~~57~~ ⁵⁸ ~~58~~ ⁵⁹ ~~59~~ ⁶⁰ ~~60~~ ⁶¹ ~~61~~ ⁶² ~~62~~ ⁶³ ~~63~~ ⁶⁴ ~~64~~ ⁶⁵ ~~65~~ ⁶⁶ ~~66~~ ⁶⁷ ~~67~~ ⁶⁸ ~~68~~ ⁶⁹ ~~69~~ ⁷⁰ ~~70~~ ⁷¹ ~~71~~ ⁷² ~~72~~ ⁷³ ~~73~~ ⁷⁴ ~~74~~ ⁷⁵ ~~75~~ ⁷⁶ ~~76~~ ⁷⁷ ~~77~~ ⁷⁸ ~~78~~ ⁷⁹ ~~79~~ ⁸⁰ ~~80~~ ⁸¹ ~~81~~ ⁸² ~~82~~ ⁸³ ~~83~~ ⁸⁴ ~~84~~ ⁸⁵ ~~85~~ ⁸⁶ ~~86~~ ⁸⁷ ~~87~~ ⁸⁸ ~~88~~ ⁸⁹ ~~89~~ ⁹⁰ ~~90~~ ⁹¹ ~~91~~ ⁹² ~~92~~ ⁹³ ~~93~~ ⁹⁴ ~~94~~ ⁹⁵ ~~95~~ ⁹⁶ ~~96~~ ⁹⁷ ~~97~~ ⁹⁸ ~~98~~ ⁹⁹ ~~99~~ ¹⁰⁰ ~~100~~ ¹⁰¹ ~~101~~ ¹⁰² ~~102~~ ¹⁰³ ~~103~~ ¹⁰⁴ ~~104~~ ¹⁰⁵ ~~105~~ ¹⁰⁶ ~~106~~ ¹⁰⁷ ~~107~~ ¹⁰⁸ ~~108~~ ¹⁰⁹ ~~109~~ ¹¹⁰ ~~110~~ ¹¹¹ ~~111~~ ¹¹² ~~112~~ ¹¹³ ~~113~~ ¹¹⁴ ~~114~~ ¹¹⁵ ~~115~~ ¹¹⁶ ~~116~~ ¹¹⁷ ~~117~~ ¹¹⁸ ~~118~~ ¹¹⁹ ~~119~~ ¹²⁰ ~~120~~ ¹²¹ ~~121~~ ¹²² ~~122~~ ¹²³ ~~123~~ ¹²⁴ ~~124~~ ¹²⁵ ~~125~~ ¹²⁶ ~~126~~ ¹²⁷ ~~127~~ ¹²⁸ ~~128~~ ¹²⁹ ~~129~~ ¹³⁰ ~~130~~ ¹³¹ ~~131~~ ¹³² ~~132~~ ¹³³ ~~133~~ ¹³⁴ ~~134~~ ¹³⁵ ~~135~~ ¹³⁶ ~~136~~ ¹³⁷ ~~137~~ ¹³⁸ ~~138~~ ¹³⁹ ~~139~~ ¹⁴⁰ ~~140~~ ¹⁴¹ ~~141~~ ¹⁴² ~~142~~ ¹⁴³ ~~143~~ ¹⁴⁴ ~~144~~ ¹⁴⁵ ~~145~~ ¹⁴⁶ ~~146~~ ¹⁴⁷ ~~147~~ ¹⁴⁸ ~~148~~ ¹⁴⁹ ~~149~~ ¹⁵⁰ ~~150~~ ¹⁵¹ ~~151~~ ¹⁵² ~~152~~ ¹⁵³ ~~153~~ ¹⁵⁴ ~~154~~ ¹⁵⁵ ~~155~~ ¹⁵⁶ ~~156~~ ¹⁵⁷ ~~157~~ ¹⁵⁸ ~~158~~ ¹⁵⁹ ~~159~~ ¹⁶⁰ ~~160~~ ¹⁶¹ ~~161~~ ¹⁶² ~~162~~ ¹⁶³ ~~163~~ ¹⁶⁴ ~~164~~ ¹⁶⁵ ~~165~~ ¹⁶⁶ ~~166~~ ¹⁶⁷ ~~167~~ ¹⁶⁸ ~~168~~ ¹⁶⁹ ~~169~~ ¹⁷⁰ ~~170~~ ¹⁷¹ ~~171~~ ¹⁷² ~~172~~ ¹⁷³ ~~173~~ ¹⁷⁴ ~~174~~ ¹⁷⁵ ~~175~~ ¹⁷⁶ ~~176~~ ¹⁷⁷ ~~177~~ ¹⁷⁸ ~~178~~ ¹⁷⁹ ~~179~~ ¹⁸⁰ ~~180~~ ¹⁸¹ ~~181~~ ¹⁸² ~~182~~ ¹⁸³ ~~183~~ ¹⁸⁴ ~~184~~ ¹⁸⁵ ~~185~~ ¹⁸⁶ ~~186~~ ¹⁸⁷ ~~187~~ ¹⁸⁸ ~~188~~ ¹⁸⁹ ~~189~~ ¹⁹⁰ ~~190~~ ¹⁹¹ ~~191~~ ¹⁹² ~~192~~ ¹⁹³ ~~193~~ ¹⁹⁴ ~~194~~ ¹⁹⁵ ~~195~~ ¹⁹⁶ ~~196~~ ¹⁹⁷ ~~197~~ ¹⁹⁸ ~~198~~ ¹⁹⁹ ~~199~~ ²⁰⁰ ~~200~~ ²⁰¹ ~~201~~ ²⁰² ~~202~~ ²⁰³ ~~203~~ ²⁰⁴ ~~204~~ ²⁰⁵ ~~205~~ ²⁰⁶ ~~206~~ ²⁰⁷ ~~207~~ ²⁰⁸ ~~208~~ ²⁰⁹ ~~209~~ ²¹⁰ ~~210~~ ²¹¹ ~~211~~ ²¹² ~~212~~ ²¹³ ~~213~~ ²¹⁴ ~~214~~ ²¹⁵ ~~215~~ ²¹⁶ ~~216~~ ²¹⁷ ~~217~~ ²¹⁸ ~~218~~ ²¹⁹ ~~219~~ ²²⁰ ~~220~~ ²²¹ ~~221~~ ²²² ~~222~~ ²²³ ~~223~~ ²²⁴ ~~224~~ ²²⁵ ~~225~~ ²²⁶ ~~226~~ ²²⁷ ~~227~~ ²²⁸ ~~228~~ ²²⁹ ~~229~~ ²³⁰ ~~230~~ ²³¹ ~~231~~ ²³² ~~232~~ ²³³ ~~233~~ ²³⁴ ~~234~~ ²³⁵ ~~235~~ ²³⁶ ~~236~~ ²³⁷ ~~237~~ ²³⁸ ~~238~~ ²³⁹ ~~239~~ ²⁴⁰ ~~240~~ ²⁴¹ ~~241~~ ²⁴² ~~242~~ ²⁴³ ~~243~~ ²⁴⁴ ~~244~~ ²⁴⁵ ~~245~~ ²⁴⁶ ~~246~~ ²⁴⁷ ~~247~~ ²⁴⁸ ~~248~~ ²⁴⁹ ~~249~~ ²⁵⁰ ~~250~~ ²⁵¹ ~~251~~ ²⁵² ~~252~~ ²⁵³ ~~253~~ ²⁵⁴ ~~254~~ ²⁵⁵ ~~255~~ ²⁵⁶ ~~256~~ ²⁵⁷ ~~257~~ ²⁵⁸ ~~258~~ ²⁵⁹ ~~259~~ ²⁶⁰ ~~260~~ ²⁶¹ ~~261~~ ²⁶² ~~262~~ ²⁶³ ~~263~~ ²⁶⁴ ~~264~~ ²⁶⁵ ~~265~~ ²⁶⁶ ~~266~~ ²⁶⁷ ~~267~~ ²⁶⁸ ~~268~~ ²⁶⁹ ~~269~~ ²⁷⁰ ~~270~~ ²⁷¹ ~~271~~ ²⁷² ~~272~~ ²⁷³ ~~273~~ ²⁷⁴ ~~274~~ ²⁷⁵ ~~275~~ ²⁷⁶ ~~276~~ ²⁷⁷ ~~277~~ ²⁷⁸ ~~278~~ ²⁷⁹ ~~279~~ ²⁸⁰ ~~280~~ ²⁸¹ ~~281~~ ²⁸² ~~282~~ ²⁸³ ~~283~~ ²⁸⁴ ~~284~~ ²⁸⁵ ~~285~~ ²⁸⁶ ~~286~~ ²⁸⁷ ~~287~~ ²⁸⁸ ~~288~~ ²⁸⁹ ~~289~~ ²⁹⁰ ~~290~~ ²⁹¹ ~~291~~ ²⁹² ~~292~~ ²⁹³ ~~293~~ ²⁹⁴ ~~294~~ ²⁹⁵ ~~295~~ ²⁹⁶ ~~296~~ ²⁹⁷ ~~297~~ ²⁹⁸ ~~298~~ ²⁹⁹ ~~299~~ ³⁰⁰ ~~300~~ ³⁰¹ ~~301~~ ³⁰² ~~302~~ ³⁰³ ~~303~~ ³⁰⁴ ~~304~~ ³⁰⁵ ~~305~~ ³⁰⁶ ~~306~~ ³⁰⁷ ~~307~~ ³⁰⁸ ~~308~~ ³⁰⁹ ~~309~~ ³¹⁰ ~~310~~ ³¹¹ ~~311~~ ³¹² ~~312~~ ³¹³ ~~313~~ ³¹⁴ ~~314~~ ³¹⁵ ~~315~~ ³¹⁶ ~~316~~ ³¹⁷ ~~317~~ ³¹⁸ ~~318~~ ³¹⁹ ~~319~~ ³²⁰ ~~320~~ ³²¹ ~~321~~ ³²² ~~322~~ ³²³ ~~323~~ ³²⁴ ~~324~~ ³²⁵ ~~325~~ ³²⁶ ~~326~~ ³²⁷ ~~327~~ ³²⁸ ~~328~~ ³²⁹ ~~329~~ ³³⁰ ~~330~~ ³³¹ ~~331~~ ³³² ~~332~~ ³³³ ~~333~~ ³³⁴ ~~334~~ ³³⁵ ~~335~~ ³³⁶ ~~336~~ ³³⁷ ~~337~~ ³³⁸ ~~338~~ ³³⁹ ~~339~~ ³⁴⁰ ~~340~~ ³⁴¹ ~~341~~ ³⁴² ~~342~~ ³⁴³ ~~343~~ ³⁴⁴ ~~344~~ ³⁴⁵ ~~345~~ ³⁴⁶ ~~346~~ ³⁴⁷ ~~347~~ ³⁴⁸ ~~348~~ ³⁴⁹ ~~349~~ ³⁵⁰ ~~350~~ ³⁵¹ ~~351~~ ³⁵² ~~352~~ ³⁵³ ~~353~~ ³⁵⁴ ~~354~~ ³⁵⁵ ~~355~~ ³⁵⁶ ~~356~~ ³⁵⁷ ~~357~~ ³⁵⁸ ~~358~~ ³⁵⁹ ~~359~~ ³⁶⁰ ~~360~~ ³⁶¹ ~~361~~ ³⁶² ~~362~~ ³⁶³ ~~363~~ ³⁶⁴ ~~364~~ ³⁶⁵ ~~365~~ ³⁶⁶ ~~366~~ ³⁶⁷ ~~367~~ ³⁶⁸ ~~368~~ ³⁶⁹ ~~369~~ ³⁷⁰ ~~370~~ ³⁷¹ ~~371~~ ³⁷² ~~372~~ ³⁷³ ~~373~~ ³⁷⁴ ~~374~~ ³⁷⁵ ~~375~~ ³⁷⁶ ~~376~~ ³⁷⁷ ~~377~~ ³⁷⁸ ~~378~~ ³⁷⁹ ~~379~~ ³⁸⁰ ~~380~~ ³⁸¹ ~~381~~ ³⁸² ~~382~~ ³⁸³ ~~383~~ ³⁸⁴ ~~384~~ ³⁸⁵ ~~385~~ ³⁸⁶ ~~386~~ ³⁸⁷ ~~387~~ ³⁸⁸ ~~388~~ ³⁸⁹ ~~389~~ ³⁹⁰ ~~390~~ ³⁹¹ ~~391~~ ³⁹² ~~392~~ ³⁹³ ~~393~~ ³⁹⁴ ~~394~~ ³⁹⁵ ~~395~~ ³⁹⁶ ~~396~~ ³⁹⁷ ~~397~~ ³⁹⁸ ~~398~~ ³⁹⁹ ~~399~~ ⁴⁰⁰ ~~400~~ ⁴⁰¹ ~~401~~ ⁴⁰² ~~402~~ ⁴⁰³ ~~403~~ ⁴⁰⁴ ~~404~~ ⁴⁰⁵ ~~405~~ ⁴⁰⁶ ~~406~~ ⁴⁰⁷ ~~407~~ ⁴⁰⁸ ~~408~~ ⁴⁰⁹ ~~409~~ ⁴¹⁰ ~~410~~ ⁴¹¹ ~~411~~ ⁴¹² ~~412~~ ⁴¹³ ~~413~~ ⁴¹⁴ ~~414~~ ⁴¹⁵ ~~415~~ ⁴¹⁶ ~~416~~ ⁴¹⁷ ~~417~~ ⁴¹⁸ ~~418~~ ⁴¹⁹ ~~419~~ ⁴²⁰ ~~420~~ ⁴²¹ ~~421~~ ⁴²² ~~422~~ ⁴²³ ~~423~~ ⁴²⁴ ~~424~~ ⁴²⁵ ~~425~~ ⁴²⁶ ~~426~~ ⁴²⁷ ~~427~~ ⁴²⁸ ~~428~~ ⁴²⁹ ~~429~~ ⁴³⁰ ~~430~~ ⁴³¹ ~~431~~ ⁴³² ~~432~~ ⁴³³ ~~433~~ ⁴³⁴ ~~434~~ ⁴³⁵ ~~435~~ ⁴³⁶ ~~436~~ ⁴³⁷ ~~437~~ ⁴³⁸ ~~438~~ ⁴³⁹ ~~439~~ ⁴⁴⁰ ~~440~~ ⁴⁴¹ ~~441~~ ⁴⁴² ~~442~~ ⁴⁴³ ~~443~~ ⁴⁴⁴ ~~444~~ ⁴⁴⁵ ~~445~~ ⁴⁴⁶ ~~446~~ ⁴⁴⁷ ~~447~~ ⁴⁴⁸ ~~448~~ ⁴⁴⁹ ~~449~~ ⁴⁵⁰ ~~450~~ ⁴⁵¹ ~~451~~ ⁴⁵² ~~452~~ ⁴⁵³ ~~453~~ ⁴⁵⁴ ~~454~~ ⁴⁵⁵ ~~455~~ ⁴⁵⁶ ~~456~~ ⁴⁵⁷ ~~457~~ ⁴⁵⁸ ~~458~~ ⁴⁵⁹ ~~459~~ ⁴⁶⁰ ~~460~~ ⁴⁶¹ ~~461~~ ⁴⁶² ~~462~~ ⁴⁶³ ~~463~~ ⁴⁶⁴ ~~464~~ ⁴⁶⁵ ~~465~~ ⁴⁶⁶ ~~466~~ ⁴⁶⁷ ~~467~~ ⁴⁶⁸ ~~468~~ ⁴⁶⁹ ~~469~~ ⁴⁷⁰ ~~470~~ ⁴⁷¹ ~~471~~ ⁴⁷² ~~472~~ ⁴⁷³ ~~473~~ ⁴⁷⁴ ~~474~~ ⁴⁷⁵ ~~475~~ ⁴⁷⁶ ~~476~~ ⁴⁷⁷ ~~477~~ ⁴⁷⁸ ~~478~~ ⁴⁷⁹ ~~479~~ ⁴⁸⁰ ~~480~~ ⁴⁸¹ ~~481~~ ⁴⁸² ~~482~~ ⁴⁸³ ~~483~~ ⁴⁸⁴ ~~484~~ ⁴⁸⁵ ~~485~~ ⁴⁸⁶ ~~486~~ ⁴⁸⁷ ~~487~~ ⁴⁸⁸ ~~488~~ ⁴⁸⁹ ~~489~~ ⁴⁹⁰ ~~490~~ ⁴⁹¹ ~~491~~ ⁴⁹² ~~492~~ ⁴⁹³ ~~493~~ ⁴⁹⁴ ~~494~~ ⁴⁹⁵ ~~495~~ ⁴⁹⁶ ~~496~~ ⁴⁹⁷ ~~497~~ ⁴⁹⁸ ~~498~~ ⁴⁹⁹ ~~499~~ ⁵⁰⁰ ~~500~~ ⁵⁰¹ ~~501~~ ⁵⁰² ~~502~~ ⁵⁰³ ~~503~~ ⁵⁰⁴ ~~504~~ ⁵⁰⁵ ~~505~~ ⁵⁰⁶ ~~506~~ ⁵⁰⁷ ~~507~~ ⁵⁰⁸ ~~508~~ ⁵⁰⁹ ~~509~~ ⁵¹⁰ ~~510~~ ⁵¹¹ ~~511~~ ⁵¹² ~~512~~ ⁵¹³ ~~513~~ ⁵¹⁴ ~~514~~ ⁵¹⁵ ~~515~~ ⁵¹⁶ ~~516~~ ⁵¹⁷ ~~517~~ ⁵¹⁸ ~~518~~ ⁵¹⁹ ~~519~~ ⁵²⁰ ~~520~~ ⁵²¹ ~~521~~ ⁵²² ~~522~~ ⁵²³ ~~523~~ ⁵²⁴ ~~524~~ ⁵²⁵ ~~525~~ ⁵²⁶ ~~526~~ ⁵²⁷ ~~527~~ ⁵²⁸ ~~528~~ ⁵²⁹ ~~529~~ ⁵³⁰ ~~530~~ ⁵³¹ ~~531~~ ⁵³² ~~532~~ ⁵³³ ~~533~~ ⁵³⁴ ~~534~~ ⁵³⁵ ~~535~~ ⁵³⁶ ~~536~~ ⁵³⁷ ~~537~~ ⁵³⁸ ~~538~~ ⁵³⁹ ~~539~~ ⁵⁴⁰ ~~540~~ ⁵⁴¹ ~~541~~ ⁵⁴² ~~542~~ ⁵⁴³ ~~543~~ ⁵⁴⁴ ~~544~~ ⁵⁴⁵ ~~545~~ ⁵⁴⁶ ~~546~~ ⁵⁴⁷ ~~547~~ ⁵⁴⁸ ~~548~~ ⁵⁴⁹ ~~549~~ ⁵⁵⁰ ~~550~~ ⁵⁵¹ ~~551~~ ⁵⁵² ~~552~~ ⁵⁵³ ~~553~~ ⁵⁵⁴ ~~554~~ ⁵⁵⁵ ~~555~~ ⁵⁵⁶ ~~556~~ ⁵⁵⁷ ~~557~~ ⁵⁵⁸ ~~558~~ ⁵⁵⁹ ~~559~~ ⁵⁶⁰ ~~560~~ ⁵⁶¹ ~~561~~ ⁵⁶² ~~562~~ ⁵⁶³ ~~563~~ ⁵⁶⁴ ~~564~~ ⁵⁶⁵ ~~565~~ ⁵⁶⁶ ~~566~~ ⁵⁶⁷ ~~567~~ ⁵⁶⁸ ~~568~~ ⁵⁶⁹ ~~569~~ ⁵⁷⁰ ~~570~~ ⁵⁷¹ ~~571~~ ⁵⁷² ~~572~~ ⁵⁷³ ~~573~~ ⁵⁷⁴ ~~574~~ ⁵⁷⁵ ~~575~~ ⁵⁷⁶ ~~576~~ ⁵⁷⁷ ~~577~~ ⁵⁷⁸ ~~578~~ ⁵⁷⁹ ~~579~~ ⁵⁸⁰ ~~580~~ ⁵⁸¹ ~~581~~ ⁵⁸² ~~582~~ ⁵⁸³ ~~583~~ ⁵⁸⁴ ~~584~~ ⁵⁸⁵ ~~585~~ ⁵⁸⁶ ~~586~~ ⁵⁸⁷ ~~587~~ ⁵⁸⁸ ~~588~~ ⁵⁸⁹ ~~589~~ ⁵⁹⁰ ~~590~~ ⁵⁹¹ ~~591~~ ⁵⁹² ~~592~~ ⁵⁹³ ~~593~~ ⁵⁹⁴ ~~594~~ ⁵⁹⁵ ~~595~~ ⁵⁹⁶ ~~596~~ ⁵⁹⁷ ~~597~~ ⁵⁹⁸ ~~598~~ ⁵⁹⁹ ~~599~~ ⁶⁰⁰ ~~600~~ ⁶⁰¹ ~~601~~ ⁶⁰² ~~602~~ ⁶⁰³ ~~603~~ ⁶⁰⁴ ~~604~~ ⁶⁰⁵ ~~605~~ ⁶⁰⁶ ~~606~~ ⁶⁰⁷ ~~607~~ ⁶⁰⁸ ~~608~~ ⁶⁰⁹ ~~609~~ ⁶¹⁰ ~~610~~ ⁶¹¹ ~~611~~ ⁶¹² ~~612~~ ⁶¹³ ~~613~~ ⁶¹⁴ ~~614~~ ⁶¹⁵ ~~615~~ ⁶¹⁶ ~~616~~ ⁶¹⁷ ~~617~~ ⁶¹⁸ ~~618~~ ⁶¹⁹ ~~619~~ ⁶²⁰ ~~620~~ ⁶²¹ ~~621~~ ⁶²² ~~622~~ ⁶²³ ~~623~~ ⁶²⁴ ~~624~~ ⁶²⁵ ~~625~~ ⁶²⁶ ~~626~~ ⁶²⁷ ~~627~~ ⁶²⁸ ~~628~~ ⁶²⁹ ~~629~~ ⁶³⁰ ~~630~~ ⁶³¹ ~~631~~ ⁶³² ~~632~~ ⁶³³ ~~633~~ ⁶³⁴ ~~634~~ ⁶³⁵ ~~635~~ ⁶³⁶ ~~636~~ ⁶³⁷ ~~637~~ ⁶³⁸ ~~638~~ ⁶³⁹ ~~639~~ ⁶⁴⁰ ~~640~~ ⁶⁴¹ ~~641~~ ⁶⁴² ~~642~~ ⁶⁴³ ~~643~~ ⁶⁴⁴ ~~644~~

Construction Details

Fence and Gate Barriers

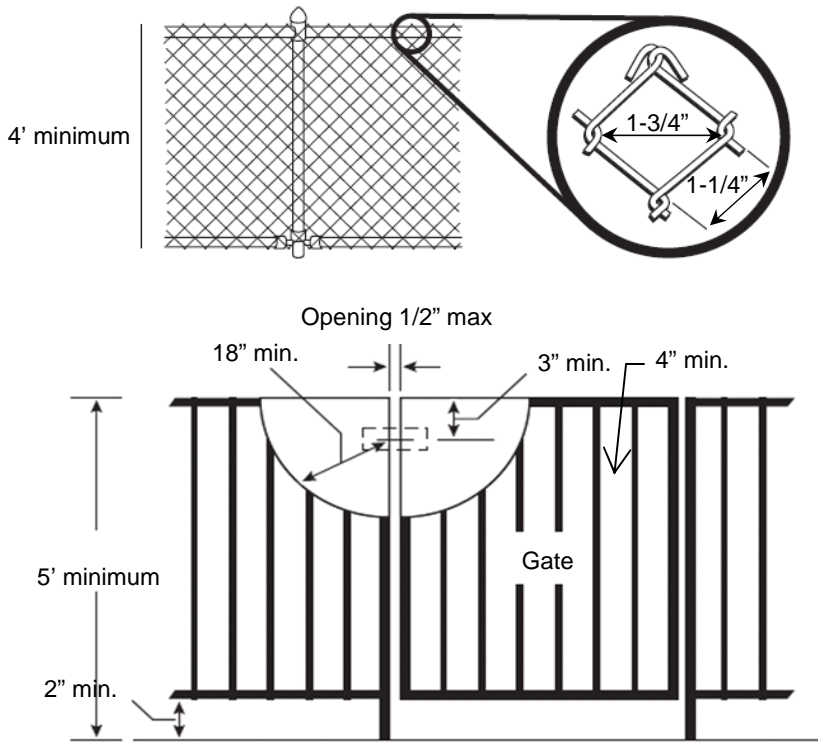

- A fence or other permanent barrier, such as a wall, is required to be completely around the pool. If the house is part of the barrier, the doors leading from the house to the pool must be protected with an alarm.
- The fence or other barrier must meet the height requirements in the City Code (4' minimum).
- Details for a chain link fence barrier is shown. A 1-3/4 x 1-1/3" maximum opening allowed.
- Details for a vertical fence barrier is shown. A 4" maximum opening allowed.
- Gate must swing outwards away from pool.

Required Inspections (cont.)

8. Pool Final. Made after the pool and all associated construction is complete and ready for use.

- The pool must be full of water and all equipment, lights, ladders, steps, and other pool accessories in place, connected, and working as designed for a completed ready for use pool.
- All permanent fences, gates, and entry warning alarms must be in place and working.
- All life safety equipment must be in place.
- All site work, walks, drives, paved areas, and landscaping included in the plans submitted at permitting must have final inspections, and sign-off's by the various departments and authorities as required.

Note for commercial pools: In addition to the City's inspection, County Health Department Inspectors must perform their inspections before the City issues a permit for the pool. Pool permit holders must provide the written proof of passing this required health department inspection, if necessary.

How do I schedule a required inspection?

Please call the inspection line and leave all information requested in the message. Inspection requests received before 1:00pm will be performed the next business day.

Want to know more? Need more help?

We hope you found the information in this guide useful. If you have any questions, please feel free to contact us at 602-975-6100.

Contact MISS DIG prior to digging on your lot.